

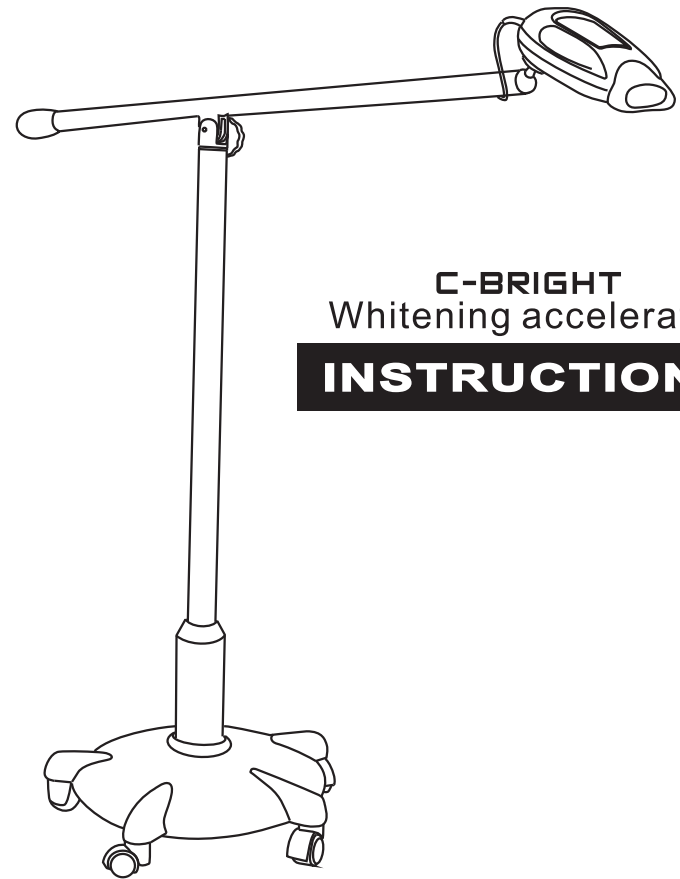

Ver2.0



**C-BRIGHT**  
Whitening accelerator

**INSTRUCTIONS**

# CONTENT

<b>Introduction</b>	1
<b>Intended use/indications</b>	2
<b>Contraindications</b>	2
<b>Adverse Reactions</b>	2
<b>Precautions</b>	3
<b>Contents</b>	4
<b>Installation</b>	6
<b>Use Method</b>	10
<b>Trouble Shooting</b>	13
<b>Service and Maintenance</b>	14
<b>Guarantee</b>	14
<b>Technical Specifications</b>	15
<b>Standard Symbols</b>	16

## Introduction

Congratulations on the purchase of C-Bright, Prior to using this product, please read this instruction carefully for setup, usage and maintenance instructions. Please keep this instruction handy as a reference for your whitening accelerator.

## Principle

The C-Bright teeth whitening accelerator is using a strong blue LED light with a specifically wavelength (between 420-490nm), this light activates tooth whitener, which oxidize the tooth stains on both the tooth surface and deep inside the dentin to achieve the effect of teeth whitening.

## Features

- Double handles, drug type arm, multi-angle adjustment to make the operation more flexibly
- Unique semi-circular head design, both arches whitened at the same time
- 6pcs high power LED, fan-cooled  
10s and 30s as a curing light, 1-30minutes as a whitening accelerator
- 6 light intensities, suitable for more brands tooth whitening gel
- LCD module screen shows all the information, all the operation is so easy
- Integrated type is available

## Intended use/indications

C-Bright is an electronic device used to whiten teeth.

## Contraindications

- In case where a patient has been fitted with an implanted heart pacemaker (or other electrical instrument) and has been cautioned against the use of small electrical appliances (such as electric shavers, hair dryers etc.) It is recommended that the C-Bright not be used.
- Don't use this machine for the persons under the age of 16, the pregnant women and the patients with severe gum disease, such as :
  - ① one with injuries of the oral cavity
  - ② one having broken teeth or lack of some teeth
  - ③ one having uncrowned or defective dental plate incisors
  - ④ one suffering from periodontal diseases
  - ⑤ one with serious dental calculus

## Adverse Reactions

None known.

## Precautions

Before using, the user shall determine the suitability of the product for its intended use and the user assumes all risk and liability whatsoever in connection with such use.

- C-Bright is only used by a properly licensed practitioner.
- The manufacturer will not take any responsibility for any malfunction, damage, or accident of personal bodily injury due to the improper maintenance, or repair of the whitening accelerator by parties other than us.
- Before connecting the power, make sure that the power voltage is accord with the voltage range. Improper voltage would damage the unit and cause the danger to the patient and/or the operator.
- After the installation, user should test the stability of equipment first. We does not advise the use of C-Bright on patients fitted with pacemakers (or other electrical instrument) for safety reasons.
- Do not expose C-Bright to any liquid.
- C-Bright must be stored in normal temperature (< 70°C) and humidity conditions.
- Do not use in the presence of inflammable products.
- Don't stare at the light with your eyes without protection; it's harmful to your eyes. In the operation, patient should wear the protective glass to avoid the damage of eyes.
- Loosen the locknut and handwheel (the flood type's) first to adjust position of the whitening accelerator. Or it will cut the working life of whitening accelerator.

# Contents

Before the first using, please check the accessories and make sure they are all in good condition.

## C-bright (Floor type)

C-bright (Floor type)					
1	Whitening unit	6	Handwheel	11	Fixed nut
2	Silica muzzle	7	Vertical post	12	Power cord
3	Locknut	8	Collar	13	Balancing weight
4	Circle screws	9	Coupling	14	Eye goggles
5	Horizontal arm	10	Mobile base	15	Instructions

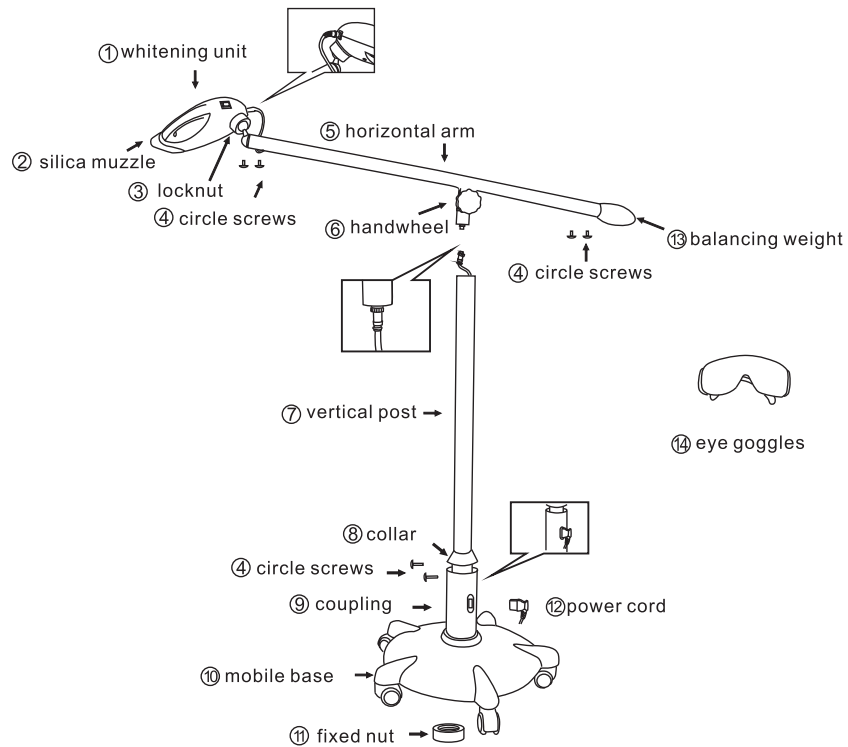

4

## C-bright b(Integrated type)

C-bright b (Integrated type)					
1	Whitening unit	5	Horizontal arm part	9	Hexagon screws
2	Silica muzzle	6	Plastic gaskets	10	Adaptor
3	Locknut	7	Semicircle plastic	11	Eye goggles
4	Circle screws	8	Fixing ring parts	12	Instructions

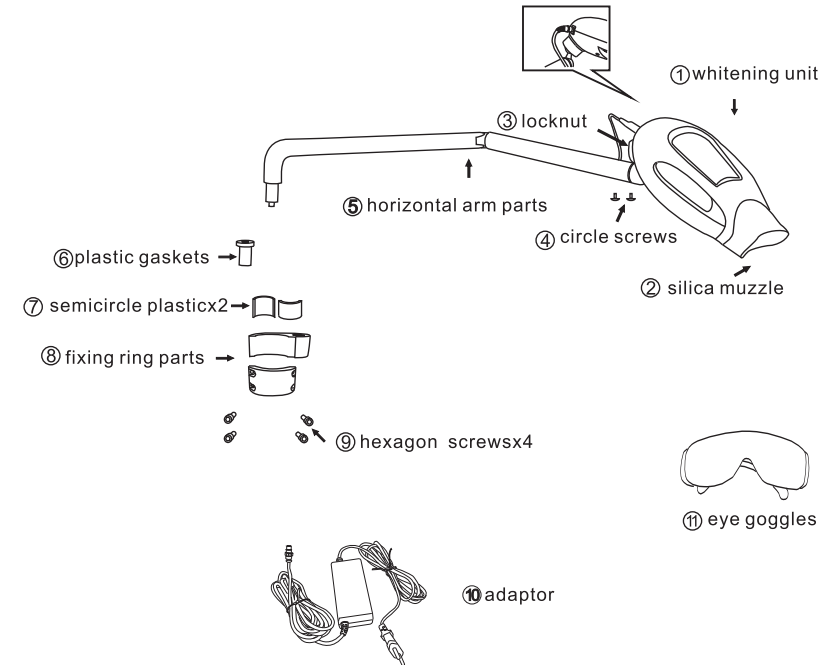

5

## INSTALLATION

### C-bright (Floor type)

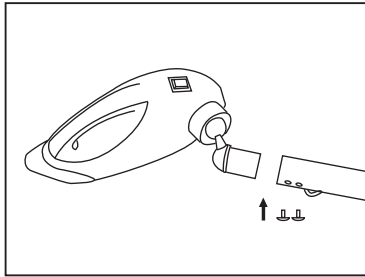

1. Connect the whitening unit and horizontal arm with the two circle screws which tightened in the whitening unit, please take them out first.

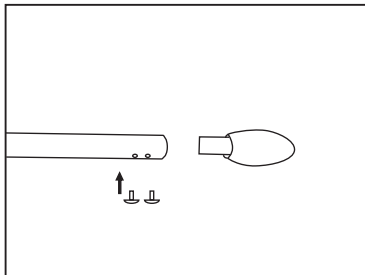

2. Insert the balancing weight into the horizontal arm and fix with the two circle screws which tightened in the balancing weight, please take them out first.

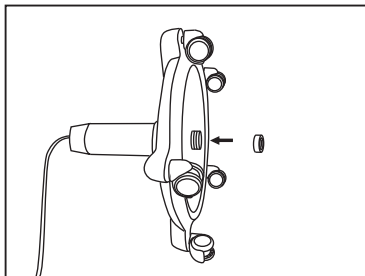

3. Connect the mobile base and the coupling by tightening the fixed nut. Make sure that it is tightened, or the vertical post will shake when the device is used.

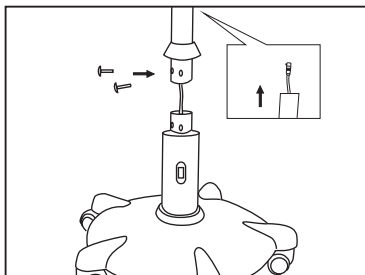

4. Pass the coupling wire through the vertical post and move the collar upward to fix the vertical post with the two circle screws which tightened in the coupling, please take them out first.

6

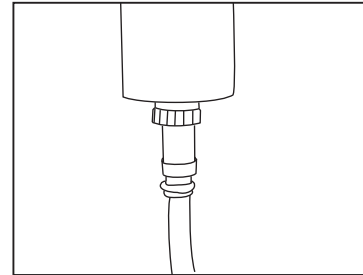

5. Connect the plugs of the horizontal arm and vertical post's.

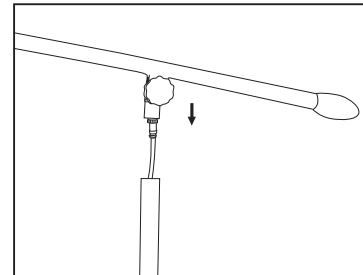

6. Put the horizontal arm on to the vertical post and adjust the position of the horizontal arm with the handwheel.

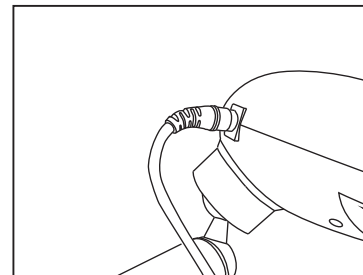

7. Put the plug of the horizontal arm into the jack of the whitening unit.

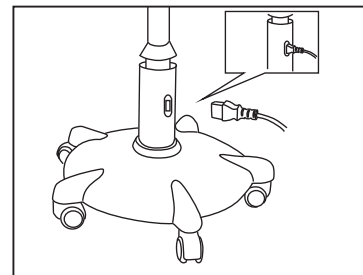

8. Connect the power cord.

7

## C-bright b

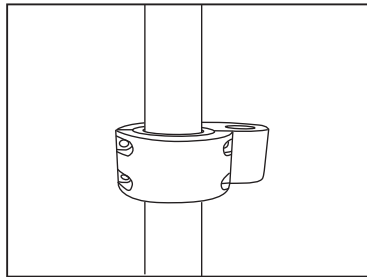

1. Clamp the king post of the dental unit with two fixing ring parts and make sure the two semicircle plastics between them.

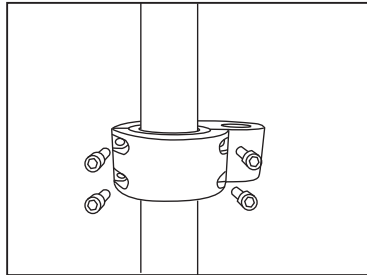

2. Fasten by the 4 hexagon screws which screwed in the fixing ring parts, please take them out first.

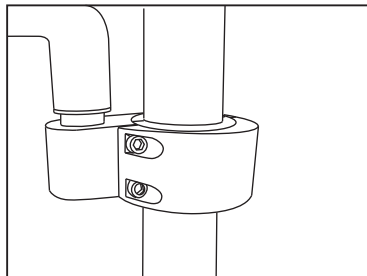

3. Insert one end of the horizontal arm parts into the hole of the fixing pedestal.

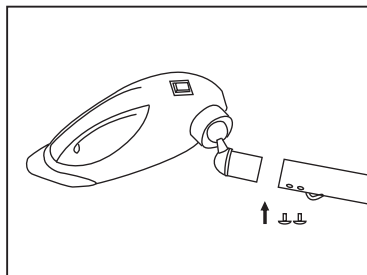

4. Connect the whitening unit and horizontal arm with the two circle screws which tightened in the whitening unit, please take them out first.

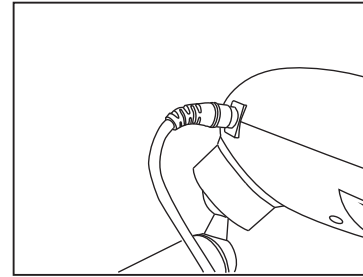

5. Put the plug of the horizontal arm into the jack of the whitening unit.

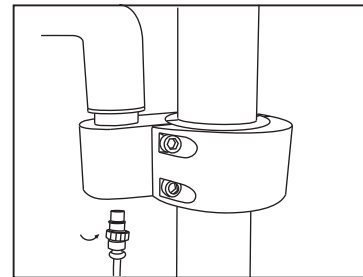

6. Connect the adaptor plugs, and turn anticlockwise to tighten.

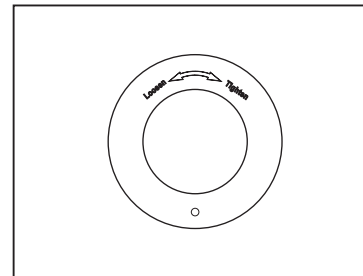

7. Adjust the whitening unit, and fasten it by rotating the locknut to dead end. (note: make sure the locknut is loose when adjust the whitening unit, or it will cut Service life of whitening unit.)

## Use Method

### Use the device

1. Turn on the main power switch. The screen displays as in Fig.1, unit is in ready status. Beeper emits 2 beeps

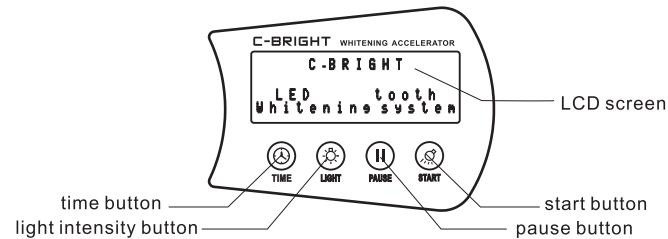

Fig. 1

2. User can select the appropriate time by pressing the TIME button, the adjustable range: 10s,30s,1m, 2m, 5m, 8m, 10m, 15m, 20m, 30m.

**Note: 10s, 30s timer can be used as a curing light to solidify the dental dam.**

3. User can select the appropriate light intensity by pressing the LIGHT button, there are six light intensity modes: LOW, LOW+, MID, MID+, HIGH, HIGH+.

**Note: HIGH+ is full power mode, HIGH is about 90%, MID+ is about 80%, MID is about 70%, LOW+ is about 60%, LOW is about 50%.**

4. Press the START button to begin work, blue light comes out and time begins countdown until 0. In the process beeper will notice the user every five minutes passed.
5. In working process, if you press the PAUSE button, the unit will break off; press the PAUSE button again, unit will continue working.
6. In working process, when you press the START button, unit will stop working and turn to ready status.
7. At the end of the process, beeper will prompt the user with three beeps.
8. In working process, fan will keep on running. Fan will keep on running 1 minute more after timer finished.

### Treatment procedure:

1. Before operation, the dentist should check the oral cavity, and communicate with the patient.
2. Evaluate and record the patient's pre-whitening treatment tooth shade, also could choose to file the pre-treatment shade of patient's teeth by taking a picture.
3. Compounding flour of pumice and a little water to polish the surface of tooth. Let the patient rinses out and make sure the teeth surface is dry.
4. Make sure that the patient is comfortable after putting the lip retractor inside.
5. Put the absorbent cotton slivers into the inside of cheek, imbrue the lip oil, and wear the tissue.
6. Paint the dental dam on the gum with thickness of 2-4mm and an extra 0.5mm extension below the gum. The dentist and the patient put on the eye goggles. Adjust the lamp, irradiate to the surface of the patient's teeth vertically. Switch the power on and preset 10 seconds or 30 seconds for the solidification of the dental dam. Switch the light on the teeth and make sure that the dental dam has been solidified so as to protect the gum.
7. Mix the hydrogen peroxide and the whitening powder into paste (only the paste which does not drop off the brush reaches the standard).
8. Paint the whitening gel (the paste) on 16 or more dry teeth with the thickness of 2or 3mm.
9. Adjust the whitening accelerator and choose different modes(light intensity and timer) accordingly.
10. Suppose 8 minutes or 10 minutes as a period of treatment. Switch the light on. The machine will stop automatically while the time finished and beeper will emit 3 times for notice. Remove the lamp and suck away the whitening gel. Clean the gel with the cotton rolls if necessary and no rinse is needed.
11. Repeat step 7-10 twice to carry on the second and the third cycles.
12. Usually, 3 cycles treatment will bring a bright result.
13. At the completion of the treatment period the whitening compound will be suctioned and washed off. Then dental dam and any other isolating materials or devices will be removed. And patient should clean the oral cavity by rinsing out.

14. After the bleaching treatment has been completed the dentist should make another shade evaluation so to see how much whitening has been achieved. The dentist should document the post treatment whitening outcome with a picture too.

**Precautions for use:**

- 1) Keep away from colored drinks and food (such as smoke, black tea, coffee, wine etc ) for 2 or 3 days after the treatment.
- 2) Avoid cold drinks or hot drinks for the first 24 hours if there is any tooth sensitivity.
- 3) It is suggested that every period of treatment should be divided into 3 periods for its best performance. (30 minutes per treatment is available.)
- 4) If the patient feels ache or has comfortlessness caused by the treatment or the medicine, the ache will disappear in one or two days.

**Treatment Range:**

C-Bright is suitable for anyone who wants to whiten their teeth. This includes people with teeth that have been stained by smoking or by substances like coffee or tea. It also whitens teeth stained by tetracycline, speckled by fluoride or hereditary discoloration.

## Trouble Shooting

If you experience a malfunction, please try to resolve the problem by using the chart below. If the machine is still malfunctioning, please contact our dealer for further instruction and assistance.

Problem	Cause	Method
Unit does not power on	Bad connection of power cord	Inspect the connection of power cord
	Main power switch is in "off" position (rear of unit)	Turn main power switch on
	Adaptor failures	Please contact our dealer
	Unit failures	Please contact our dealer
"E1" appears on the screen	LED burned out	Please contact our dealer
"E2" appears on the screen	Fan has gotten stuck from dust or debris	Remove the <i>debris</i>
	Fan failures	Please contact our dealer
"E3" appears on the screen	Supply failures	Check the power (the adaptor)



## Service and Maintenance

The instrument doesn't contain user's self serviceable parts. The service and repair should be provided by trained service personnel only.

We suggest the unit should be cleaned and disinfected before the first using.

The whitening unit and the silica gel muzzle can be cleaned with alcohol or neutral detergent; it's not allowed to use caustic or rubbing detergent.

## Guarantee

C-Bright whitening unit is guaranteed for 12 months from the date of purchase. The accessories (Silica Gel Muzzle, Protective glasses etc.) Are not covered by warranty.

The guarantee is valid for normal usage conditions. Any modification or accidental damage will render the guarantee void.

We will repair or replace, at its option, a defective unit. This warranty is in lieu of all warranties of merchantability, fitness for purpose or other warranties express or implied. We do not accept liability for any loss or damage, direct, consequential or otherwise, arising out of the use of or the inability to use the product herein described.

## Technical Specifications

C-Bright belongs to following category of medical devices:

- Protection type against electrical shock: Class II
- Protection against electrical shock: Type B
- Continuous operation
- Ingress of liquids - not protected
- Temperatures: Operating: +10°C~+40°C  
Storage: -20°C~+70°C
- Relative humidity: 10% to 90%, non-condensing

### Technical specifications:

- Light Source: 6pcs high power LED
- Light Intensity: 6 intensities, maximum >6000 mw/cm<sup>2</sup>
- Wavelength: 420nm-490nm
- Working Time: 10s,30s,1m, 2m, 5m, 8m, 10m, 15m, 20m, 30m
- Power supply: AC 100-240 V 50/60Hz, 2.5A

## Standard Symbols

On the instrument label appear standard symbols as follows:



Class II equipment



Type B applied part



Attention, consult accompanying documents



Direct current



Certified to MDD93/42/EEC